

-  Exit
-  Fire Extinguisher
-  Automated External Defibrillator

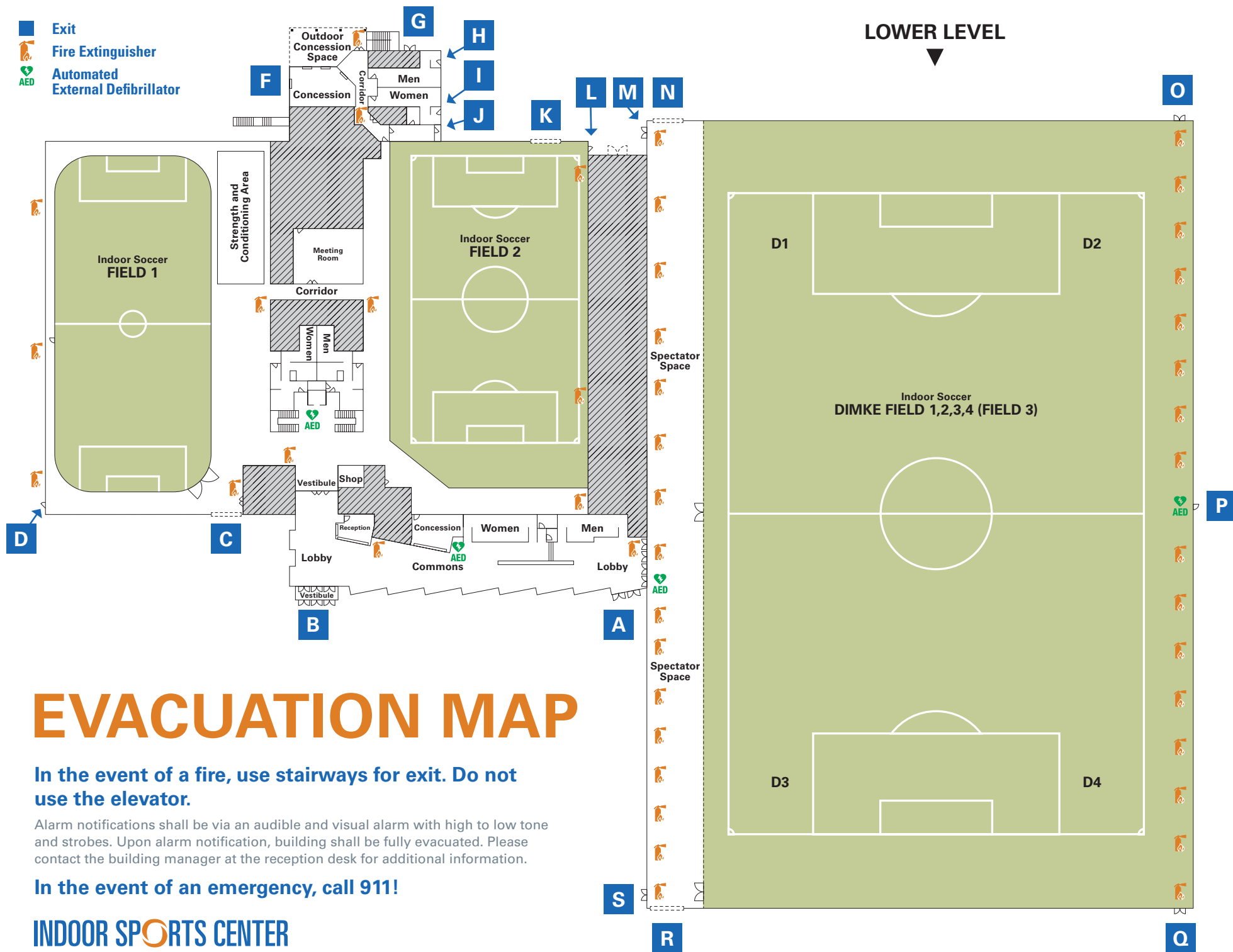

# EVACUATION MAP

**In the event of a fire, use stairways for exit. Do not use the elevator.**

Alarm notifications shall be via an audible and visual alarm with high to low tone and strobes. Upon alarm notification, building shall be fully evacuated. Please contact the building manager at the reception desk for additional information.

**In the event of an emergency, call 911!**



# EVACUATION MAP

**UPPER LEVEL**  
Skybox Restaurant  
(between Fields 1 and 2)

**E**

-  Exit
-  Fire Extinguisher
-  Automated  
External Defibrillator

**In the event of a fire, use stairways for exit. Do not use the elevator.**

Alarm notifications shall be via an audible and visual alarm with high to low tone and strobes. Upon alarm notification, building shall be fully evacuated. Please contact the building manager at the reception desk for additional information.

**In the event of an emergency, call 911!**

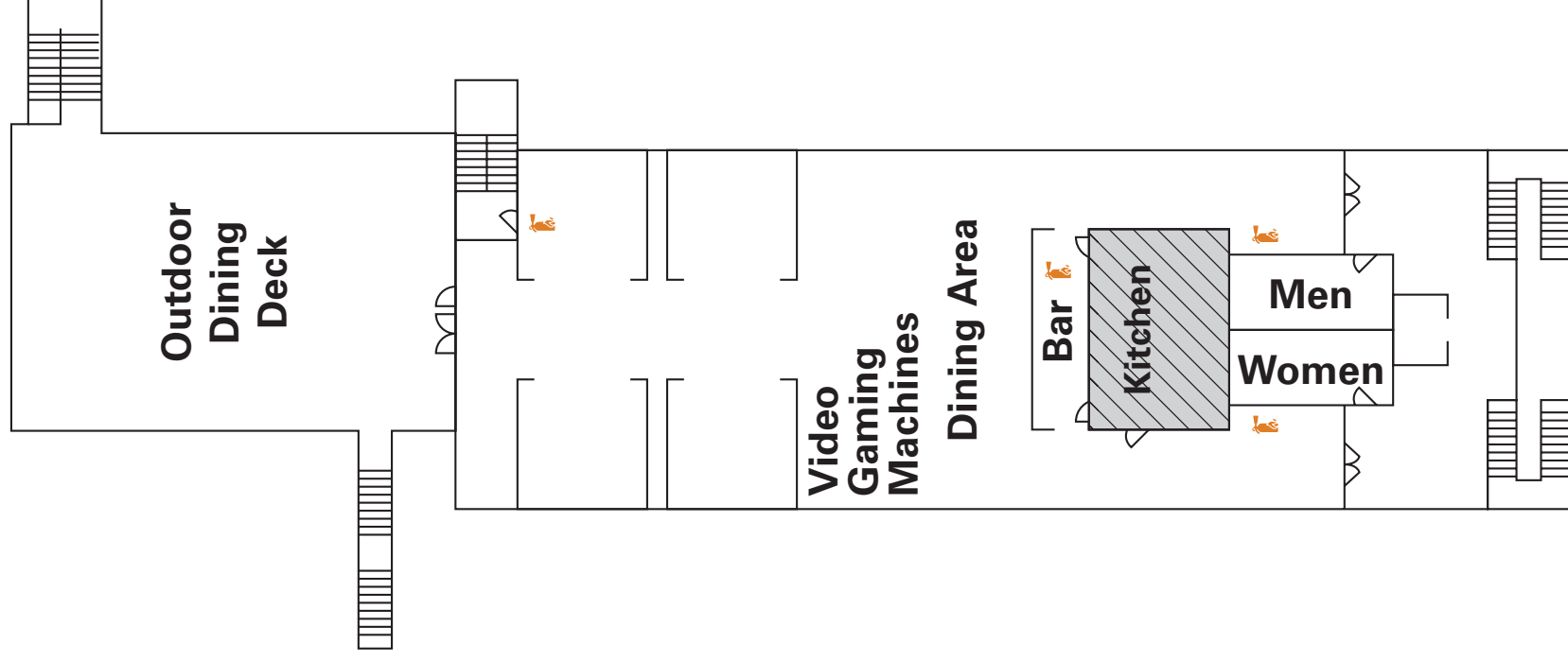

**INDOOR SPORTS CENTER**  
at Mercyhealth Sportscore Two